

## Concealed Flush Valve Connection for Water Closets; Rear Spud; 16" Rough In

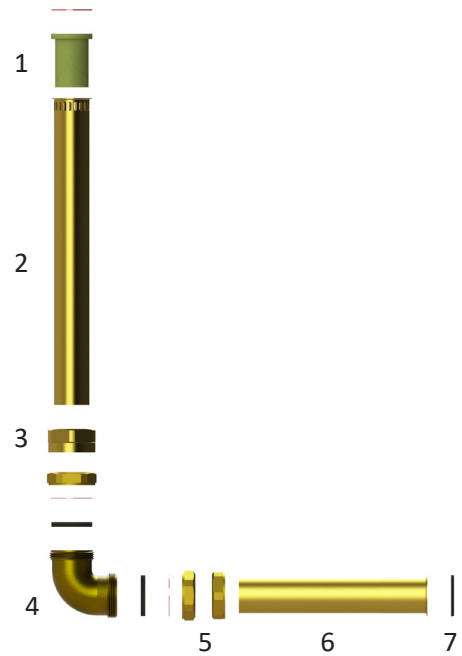

Part No. 101844

**Note:** 16" Rough in with I-CON COBALT®, COBALT Pro®, & COBALT® Secure Series flush valve bodies.



### ► Description

Flush Valve Connection Kit for 1-1/2"  
Concealed Rear Spud 16" Rough In

### Components

- (1) 103829**  
High Pressure Silicone Vacuum Breaker Kit w/ Friction Washer
- (2) 100102 : 3/4" : 13" : Raw Brass : No Trans**  
Vacuum Breaker Tube; 13"L; 1-1/2"; Raw Brass
- (3) 100107**  
Vacuum Breaker Nut; 1-1/2"; Raw Brass
- (4) 100103**  
Slip Joint Elbow, with Nuts, Gaskets & Friction Washers; 1-1/2"  
Raw Brass
- (5) 100106**  
Tail Piece Nut; 1-1/2"; Raw Brass
- (6) 101520 : 1-1/2" : 4" : Raw Brass**  
Outlet Tube; Flanged; 4"L; 1-1/2" Raw Brass
- (7) 100105**  
Tail Piece Gasket; 1-1/2"; Rigid

### Recommended Specification

I-CON Concealed Flush Valve Connection Kit 101844 is a raw brass connection kit for a concealed rear spud water closet with a 16" rough-in.

### ► Accessories

For additional accessories, see the Accessories Section of the I-CON catalog or contact our Customer Service Team for details.



 **WARNING:** Cancer and Reproductive Harm - [www.P65Warnings.ca.gov](http://www.P65Warnings.ca.gov)

This space is for Architect/Engineer approval

The information contained in this document is subject to change without notice.