

Adjustable Offset Vacuum Breaker Tube Adapter

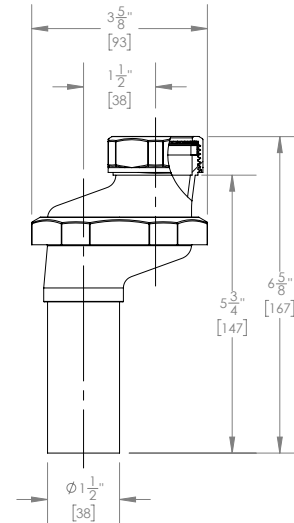

Part No. 103956

► Description

Adjustable Offset Vacuum Breaker Tube Adapter installs in line with existing vacuum breaker tube to allow for easy retrofit and alignment of water closet fixtures without the need to shut off the water supply. The adapter pivots and accommodates offsets from 0" to 1.5".

► Features

- Pivots to allow offsets from 0" - 1.5"
- Chemical resistant O-ring seal
- Chrome plated
- Vandal resistant setscrew on pivot lock nut
- Accepts standard 1.5" vacuum breaker tubes to reach finished length
- Includes rubber slip joint washer, friction washer, and anti-blowout ring

► Accessories

See Accessories Section of the I-CON catalog or contact our Customer Service Team for details.



Recommended Specification

Adjustable Offset Vacuum Breaker Tube Adapter is user adjustable to fit any fixture offset from 0" to 1.5". The cast brass adapter body has a polished, chrome-plated finish for a durable and clean aesthetic. The chemical resistant O-ring seal allows for 360° rotation of the adapter for easy installation. The flow to the fixture is unimpeded with the adapter in any orientation.

 **WARNING:** Cancer and Reproductive Harm - www.P65Warnings.ca.gov

This space is for Architect/Engineer approval

The information contained in this document is subject to change without notice.