

Rebuild Kit for 3/4" Shower Valve

Rebuild Kit Part Number: EUC-RKT-5775

SHOWER VALVE REBUILD INSTRUCTIONS

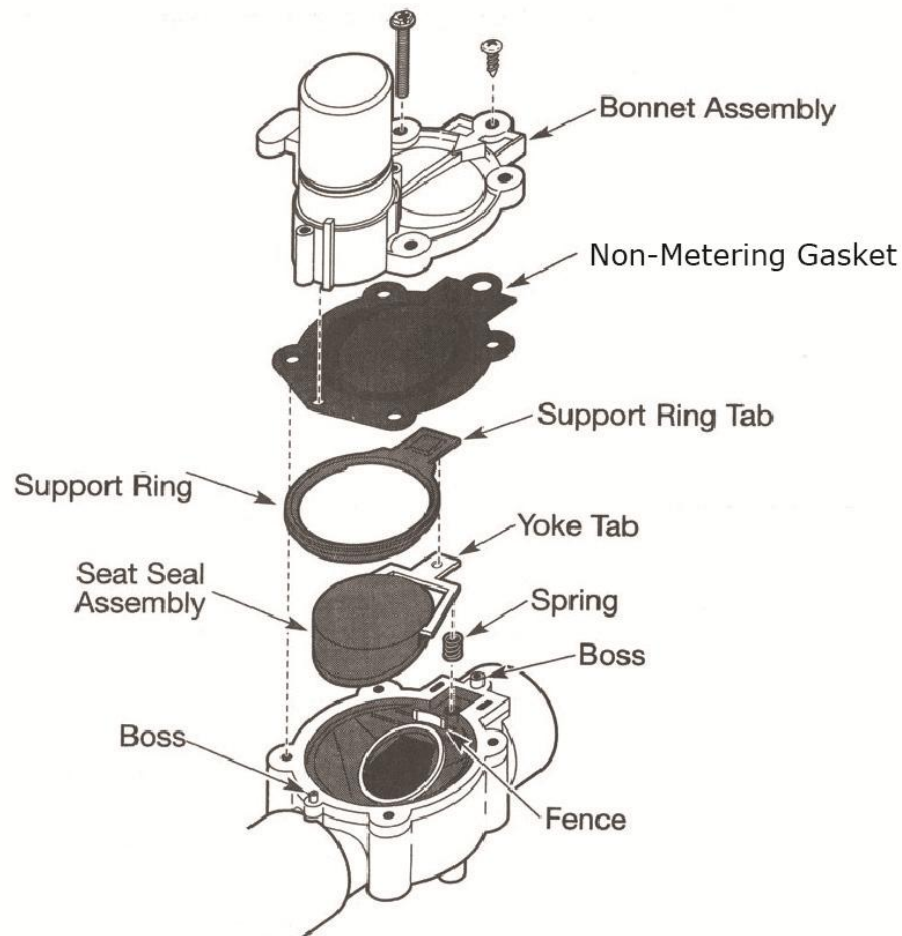

1. Remove (5) bonnet screws and valve bonnet from valve body.
2. Remove and discard rubber gasket.
3. Remove and discard gasket support ring.
4. Remove and discard seat seal assembly with yoke tab.
5. Remove and discard spring.
6. Inspect valve seat. Seat should be smooth and free of debris, nicks or cuts
7. Fit new spring in the round pocket in the valve body.
8. Hook the yoke of the new seat seal assembly behind the fence with the yoke tab fitted over the spring. Make sure that screw on the bottom of the seat seal assembly is facing down into the valve body.
9. Hold the yoke tab against the spring with your right hand and with your left hand, slide the gasket support ring tab into the body recess. Press the gasket support ring down all around so that the seat seal assembly is retained.
10. Lay the new rubber gasket over the two bosses on the valve body. The rubber gasket will have the word "top" displayed. This should face the valve bonnet.
11. Replace the valve bonnet making sure the rubber gasket is still in place over the two bosses. Once in place, secure it with the five bonnet screws.
12. If the shower valve assembly is not installed into the system, the correct assembly can be verified by reaching into the inlet and lifting the seat seal assembly with your finger.