

# Check Stop with Strainer and Clip Style Outlet Rebuild Installation Instructions

## Step 1

Remove lid, lid O-ring, screen, and outlet O-ring. Discard the screen and O-rings.



## Step 2

Using the top side of the lid as a tool, remove the core assembly and lower O-ring.



## Step 3

Disassemble the core assembly. Discard the O-rings, seal and spring.

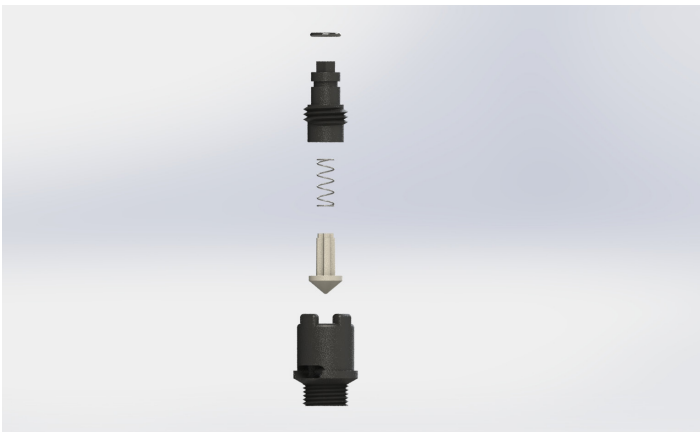

## Step 4

Reassemble the core assembly using new O-rings, seal and spring. Be sure not to over tighten the steam into the core.



## Step 5

Install core assembly and new lower O-ring into body, tighten with top side of the lid.



## Step 6

Install new lid O-ring and screen into the appropriate grooves on lid. A light coat of plumber's grease will assist with keeping the O-ring in place.



## Step 7

Install the lid assembly, hand tighten only. Install new outlet O-ring onto body.



**INSTALLATION COMPLETE**